



Flat 3 1 Silvester Road

, Waterlooville, PO8 8TD

£975 Per month



Signature Properties are delighted to bring to the market this well presented one-bedroom apartment, ideally located on Silvester Road in Cowplain, just a short walk from local shops and amenities.

The accommodation comprises a spacious and bright open-plan lounge/kitchen, featuring multiple windows that flood the space with natural light. The modern fitted kitchen includes a range of integrated appliances, including a fridge freezer, dishwasher, oven and hob, and washing machine.

The apartment offers a generously sized double bedroom with a large built-in wardrobe, alongside a contemporary bathroom fitted with a white three-piece suite and a shower over the bath.

Further benefits include gas central heating, double glazing throughout, and one allocated parking space.

Early viewing is highly recommended to fully appreciate the quality and space this property has to offer. A video tour is also available upon request.



Area Map



Floor Plans

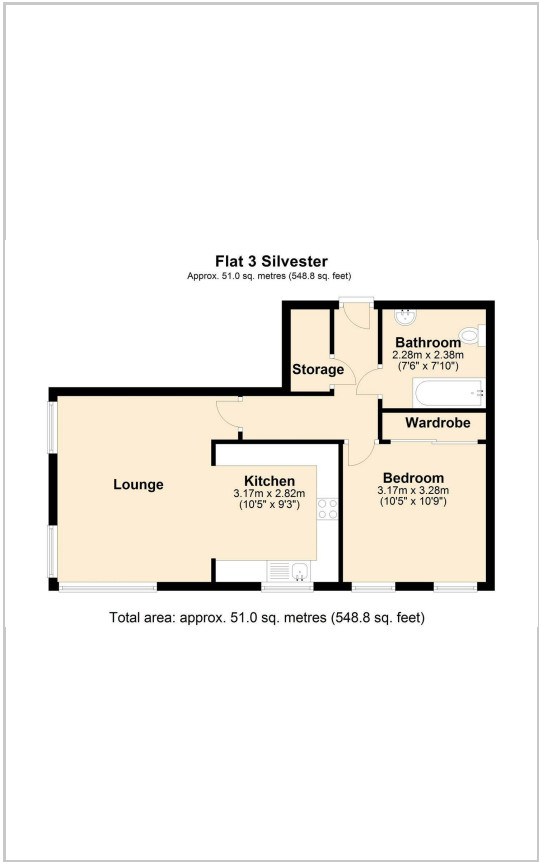

Energy Efficiency Graph

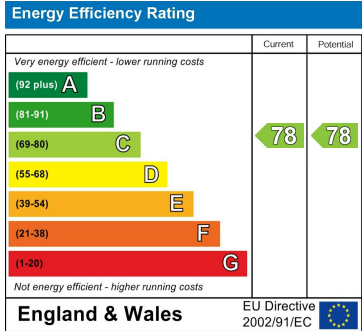

These particulars, whilst believed to be accurate are set out as a general outline only for guidance and do not constitute any part of an offer or contract. Intending purchasers should not rely on them as statements of representation of fact, but must satisfy themselves by inspection or otherwise as to their accuracy. No person in this firms employment has the authority to make or give any representation or warranty in respect of the property.